

ELEVATION
DUMPSTER DETAIL
SCALE: 1/8" = 1'-0"

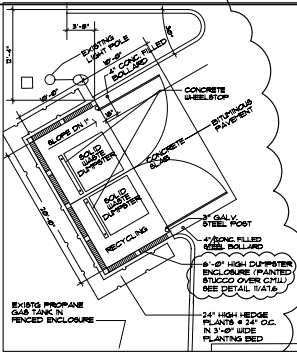

PLAN
DUMPSTER DETAIL
SCALE: 1/8" = 1'-0"

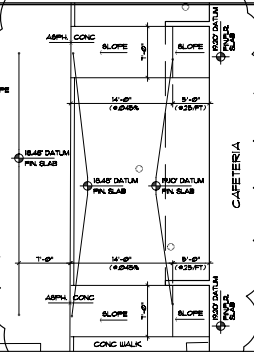

CAFETERIA WALKS
SCALE: 1/8" = 1'-0"

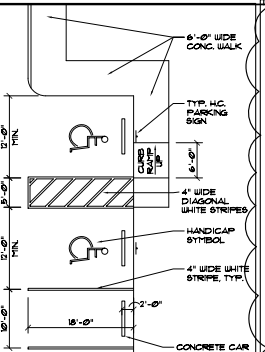

PARKING DETAIL
SCALE: 1" = 10'-0"

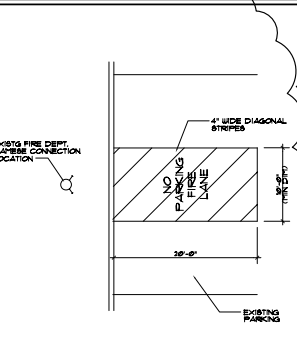

FIRE DEPT. SIAMESE CONNECTION LOCATION
SCALE: 1/8" = 1'-0"

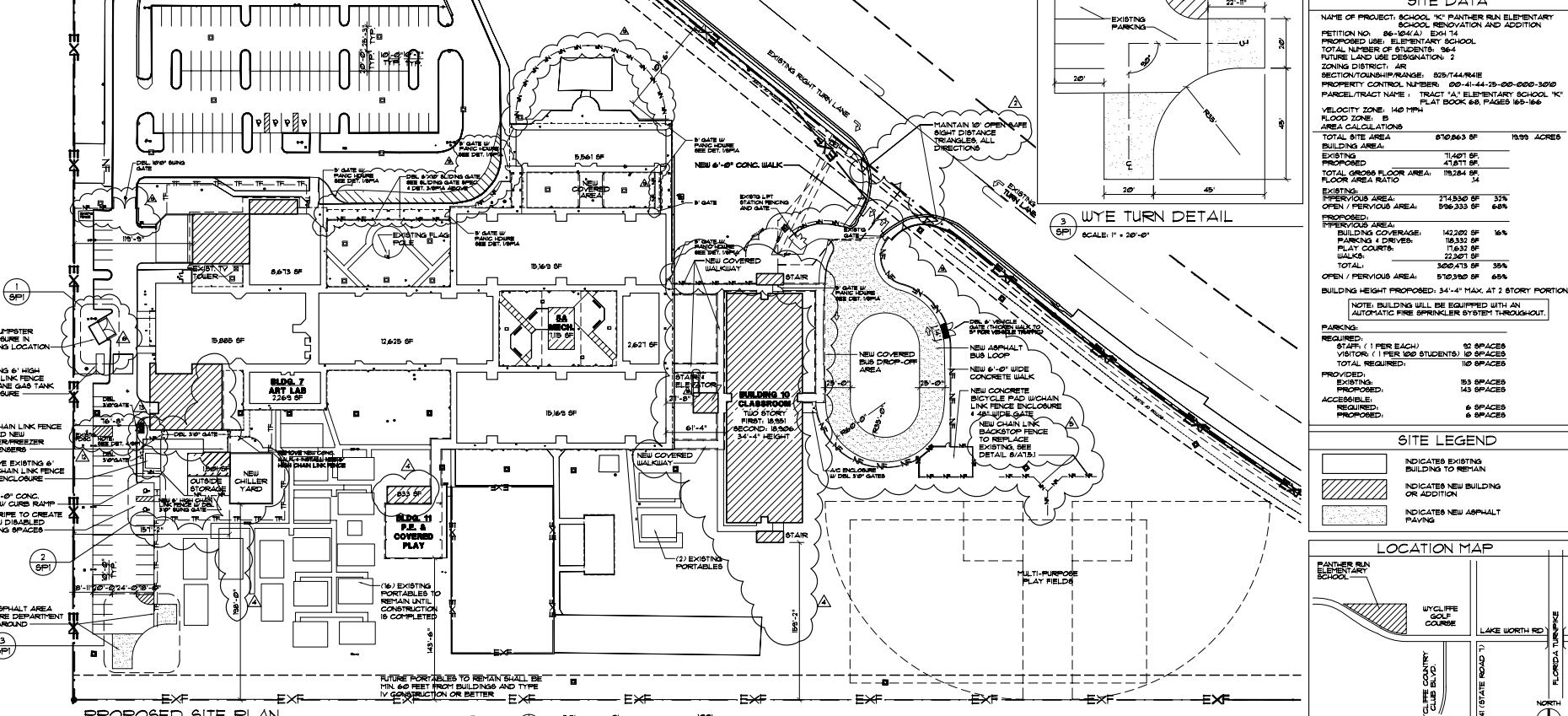

PROPOSED SITE PLAN
SCALE: 1" = 10'-0" NOTE: SEE SPEC. SECTION 02831 FOR CHAIN LINK FENCE PERFORMANCE SPEC.

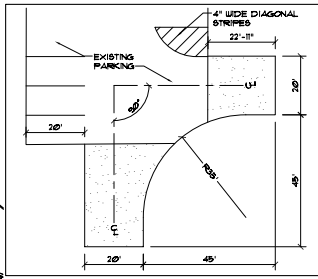

WYE TURN DETAIL
SCALE: 1" = 20'-0"

SITE DATA

NAME OF PROJECT: SCHOOL "K" PANTHER RUN ELEMENTARY SCHOOL RENOVATION AND ADDITION
 PERMIT NO. 86-104(A) EXH 14
 PROPOSED USE: ELEMENTARY SCHOOL
 TOTAL NUMBER OF STUDENTS: 1664
 FUTURE LAND USE DESIGNATION: 2
 ZONING DISTRICT: AIR
 SECTION/TOWNSHIP/RANGE: 52S/144/941E
 PROPERTY CONTROL NUMBER: 00-41-44-25-00-000-3012
 PARCEL/TRACT NAME: TRACT "A" ELEMENTARY SCHOOL "K"
 PLAT BOOK: 68, PAGES 100-106

VELOCITY ZONE: 140 MPH
 FLOOD ZONE: B
 AREA CALCULATIONS

TOTAL SITE AREA	570,863 SF	13.99 ACRES
EXISTING BUILDING AREA	71,491 SF	
PROPOSED BUILDING AREA	41,871 SF	
TOTAL GROSS FLOOR AREA	113,364 SF	
FLOOR AREA RATIO	14	
EXISTING PERVIOUS AREA	274,850 SF	31%
OPEN / PERVIOUS AREA	596,333 SF	68%
PROPOSED PERVIOUS AREA	143,202 SF	16%
BUILDING COVERAGE	18,332 SF	
PARKING 4 DRIVES	17,632 SF	
PLAY COURTS	22,267 SF	
WALKS	300,478 SF	35%
TOTAL	570,350 SF	65%
OPEN / PERVIOUS AREA	570,350 SF	65%

BUILDING HEIGHT PROPOSED: 34'-4" MAX. AT 2 STORY PORTION
 NOTE: BUILDING WILL BE EQUIPPED WITH AN AUTOMATIC FIRE SPRINKLER SYSTEM THROUGHOUT.

PARKING:

REQUIRED:	STAFF (1 PER EACH)	82 SPACES
REQUIRED:	VISITOR (1 PER 100 STUDENTS)	10 SPACES
TOTAL REQUIRED:		100 SPACES
PROVIDED:		83 SPACES
PROPOSED:		143 SPACES
ACCESSIBLE:	REQUIRED:	6 SPACES
ACCESSIBLE:	PROPOSED:	6 SPACES

SITE LEGEND

[Symbol]	INDICATES EXISTING BUILDINGS TO REMAIN
[Symbol]	INDICATES NEW BUILDING OR ADDITION
[Symbol]	INDICATES NEW ASPHALT PAVING

LOCATION MAP

